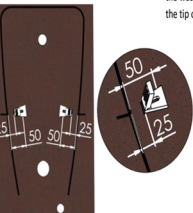
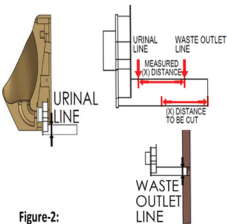


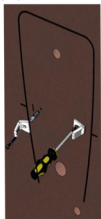
**Figure-1:**  
Prepare the water inlet and waste outlet infrastructure of the urinal as shown in the gure above. Also make sure the waste outlet is at the same level with the wall surface.



**Figure-5:**  
Remove the urinal from the wall. Make a second line that is 25mm inward, parallel to the outline where the installation holes are. Place the installation apparatus on this line. Mark the screw hole point as shown in the gure, about 50mm inwards from outmost line.

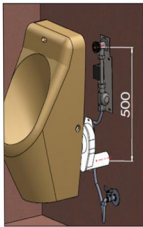


**Figure-2:**  
Place the waste outlet piece on the urinal and mark it where the back edge of the urinal lines up. Place the same outlet piece on the wall and mark it on the wall surface line. Measure the distance X between two marks as shown in the gure above. Prepare the waste outlet piece by shortening it from the tip of the pipe by X cms.

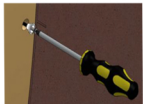


**Figure-6:**  
Drill suitable sized holes on the wall. Placexing plugs in the ho leand install the L shaped apparatus tightly.

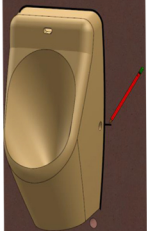
**WARNING :**  
**IN ORDER TO ACHIEVE A LEAK-PROOF CONNECTION NO SILICON SHOULD BE APPLIED TO THE SEALING GASKETS**



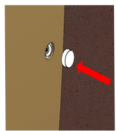
**Figure-3:**  
Place the prepared waste outlet piece in its place. Mount the installation plate of the urinary so that the distance between the center of water inlet hole and the center of waste outlet hole is 480 mm. Place the urinary on the wall temporarily.



**Figure-7:**  
After installing the photocell system and outlet/inlet pipes, place the urinal on its place on the wall. Slide the plastic ring and the screw through the side holes of the urinal. Tighten the screws.



**Figure-4:**  
Once the infrastructure is ready and the urinary is placed on the wall, draw an outline of the urinary and mark where the installation holes are.



**Figure-8:**  
Complete the installation by inserting screw caps on both sides.