

Instruțiuni de montaj

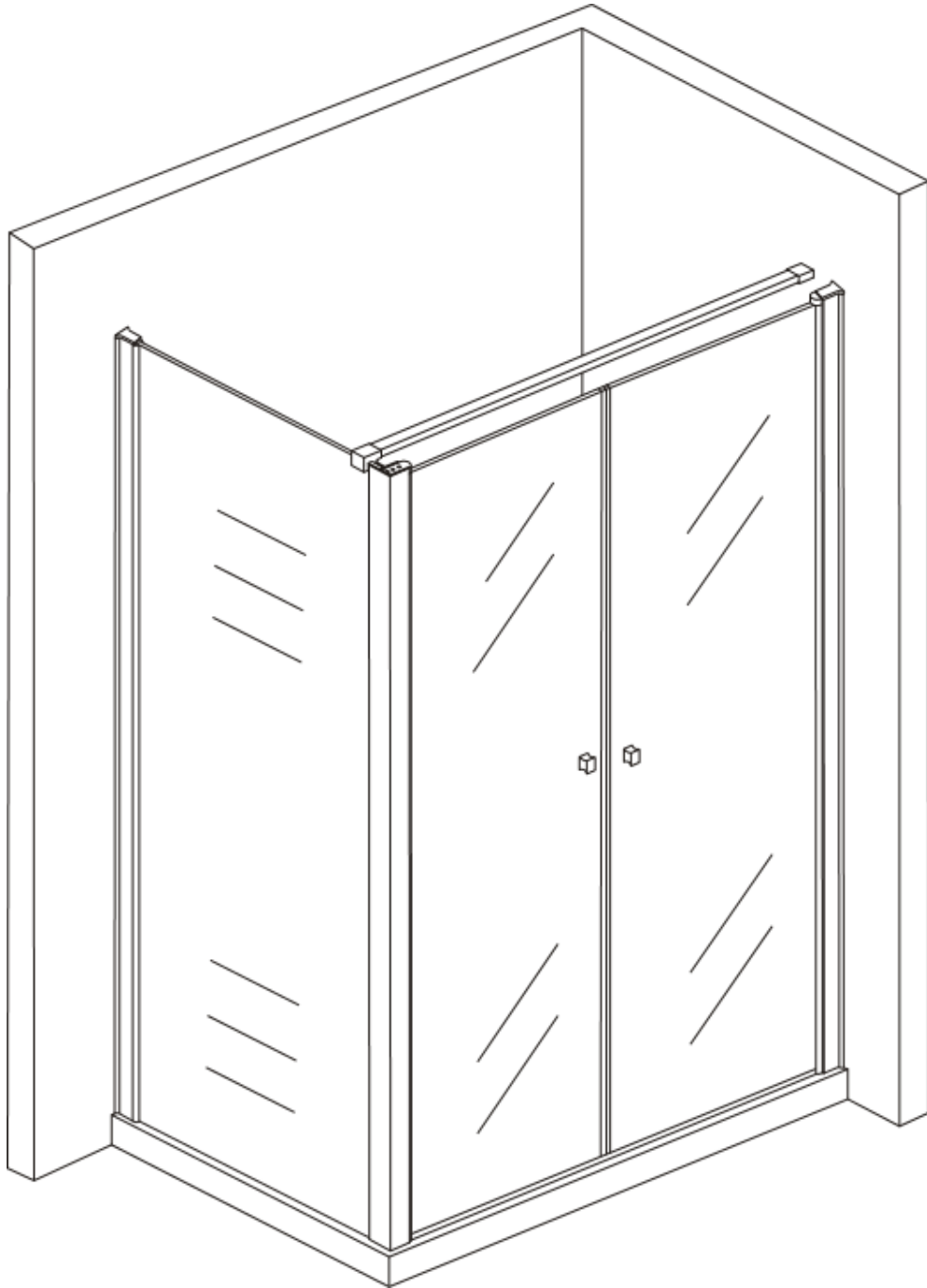

Instrument necesar

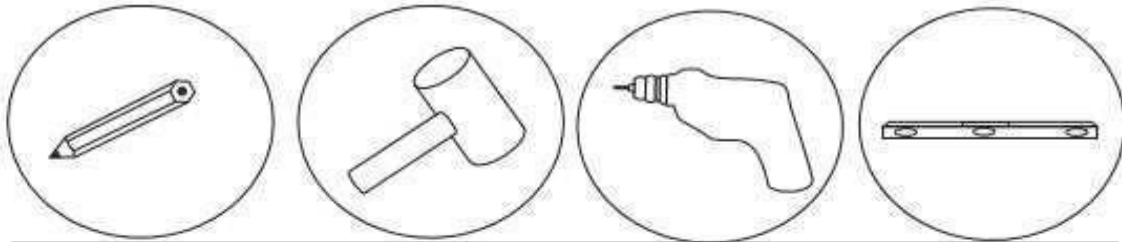

Creion

ciocan de cauciuc

bormasina

boloboc

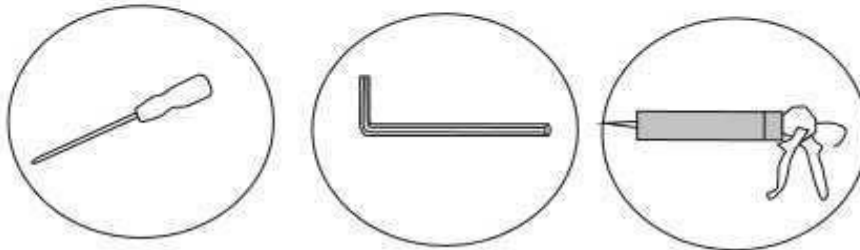

Surubelnita

cheie hexagonala

silicon

Părți

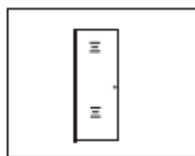

Glass

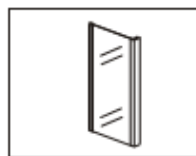

Glass



Screw

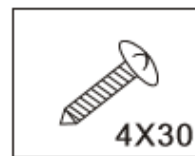

Screw

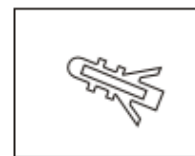

Expand tube

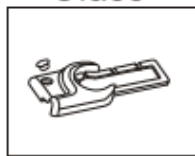

PJ-4644

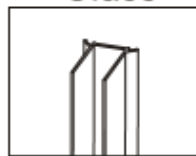

Wall profile

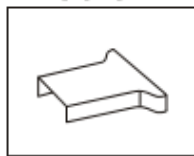

PJ-4643

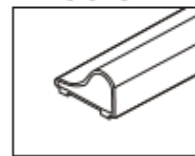

PJ-4026

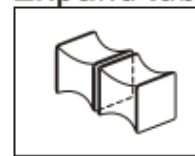

LS-1114

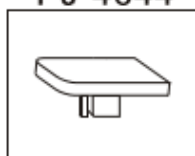

PJ-4509



water-proof gasket



LG-2301



PJ-4553



Tray



CT-6BMX90

Utilizați creionul și bolobocul, desenați liniile verticale de instalare în funcție de dimensiunile dvs.

Dimensiuni cabina	L1	L2
800X1000	771	971
800X1200	771	1171
900X1200	871	1171
900X1400	871	1371

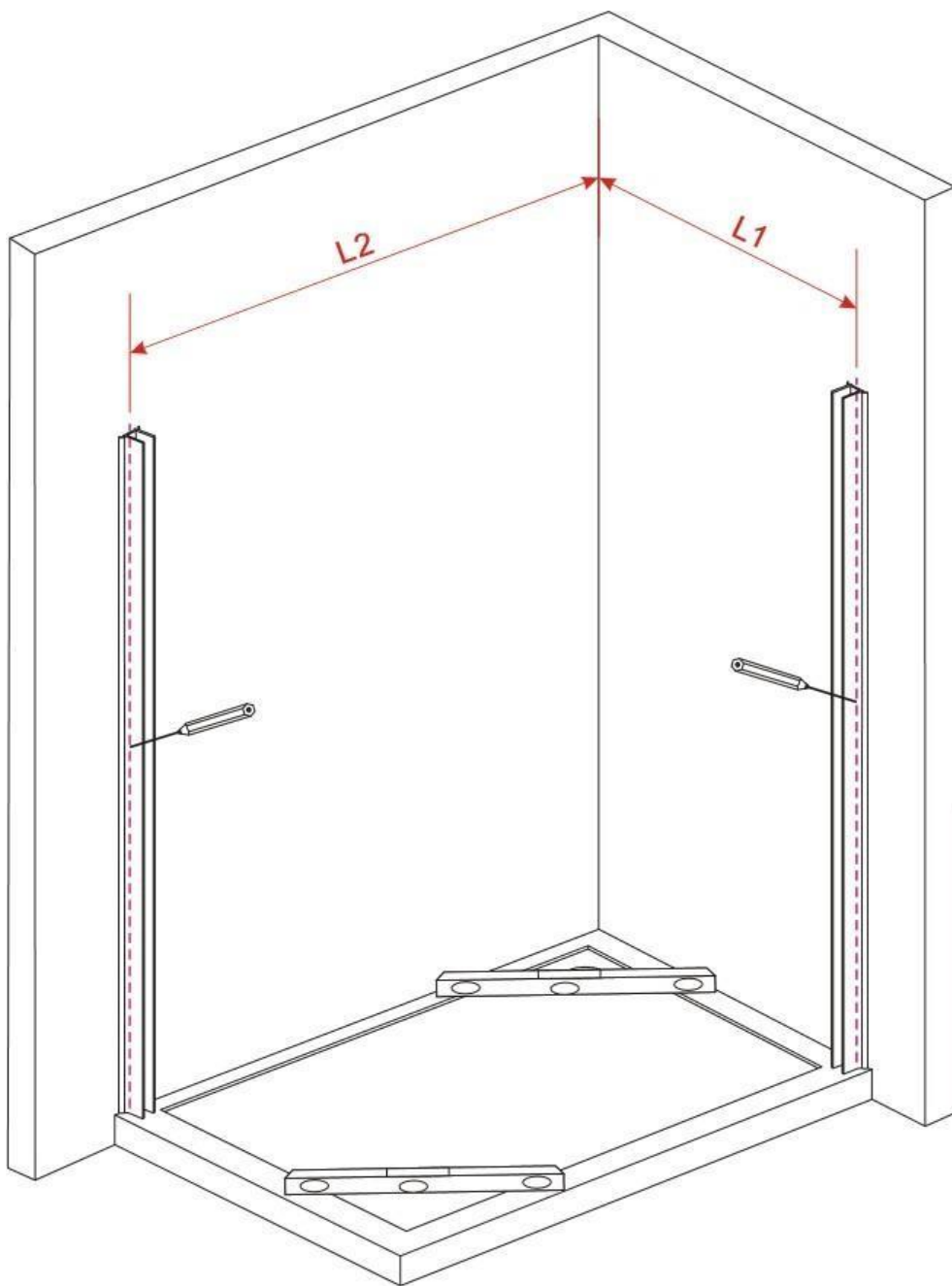

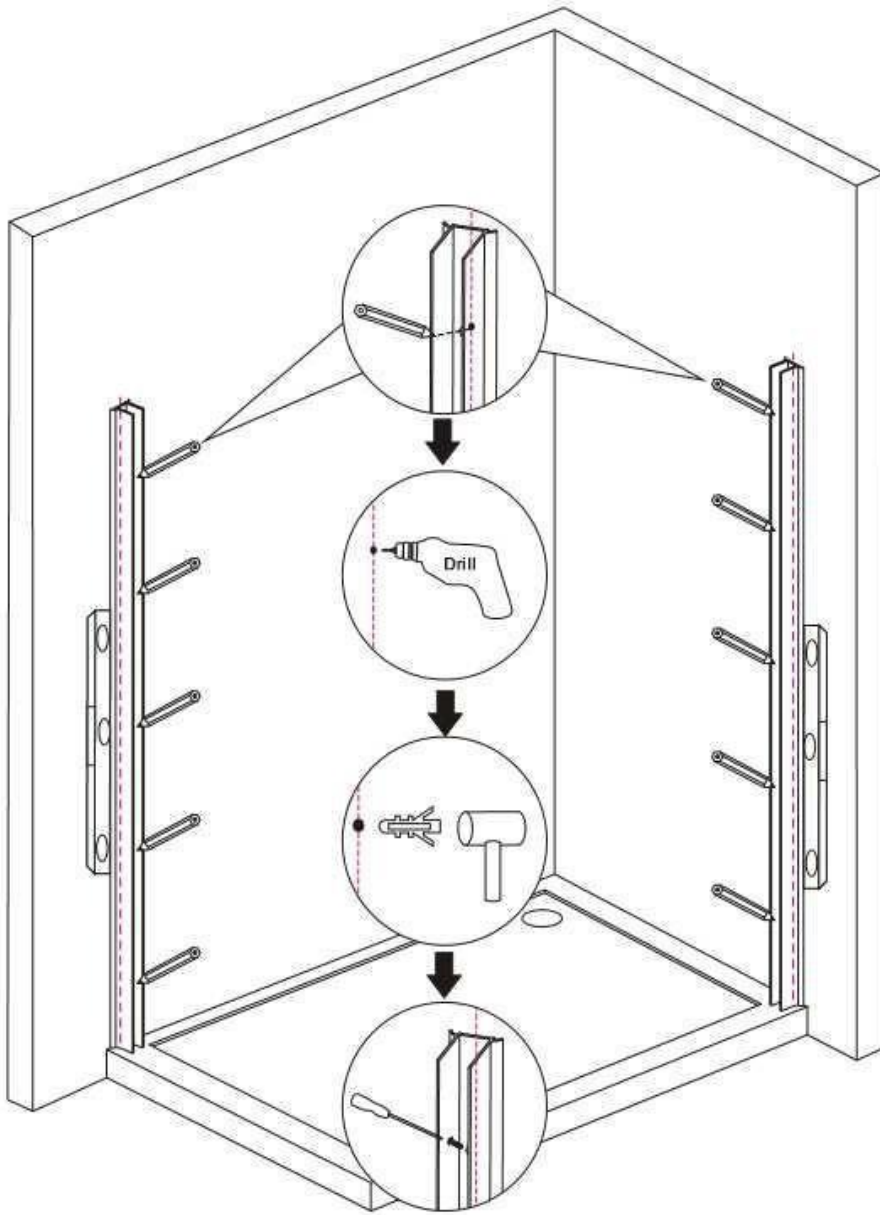
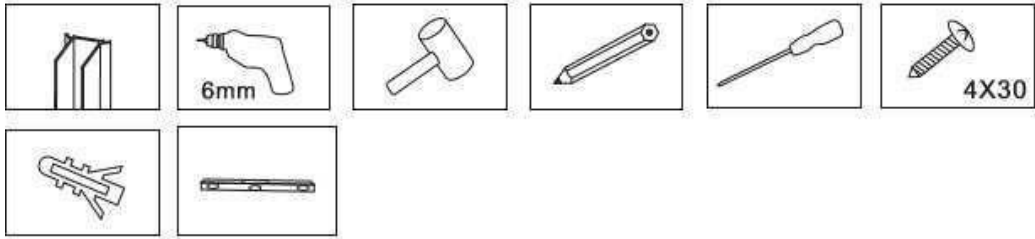

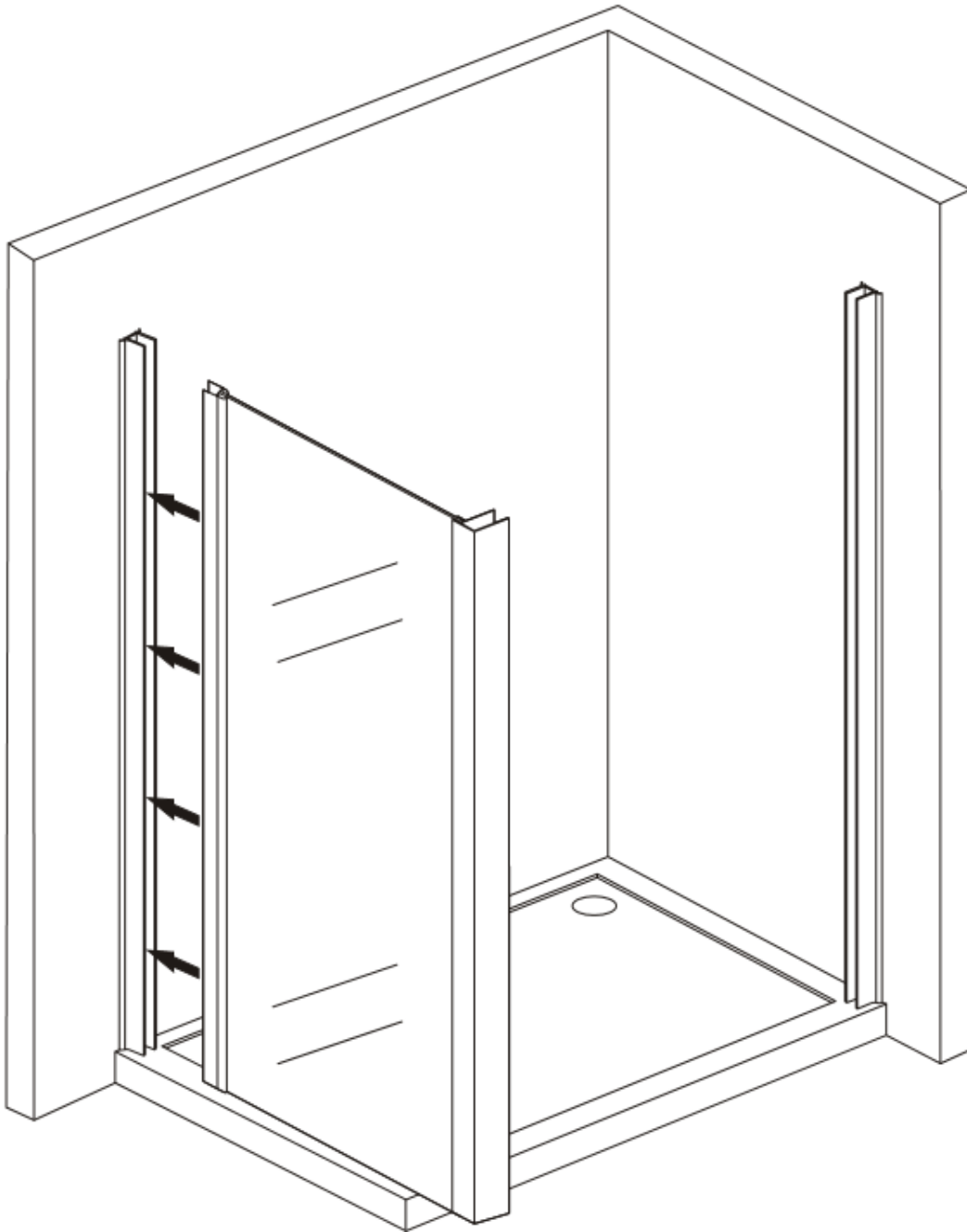
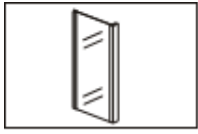

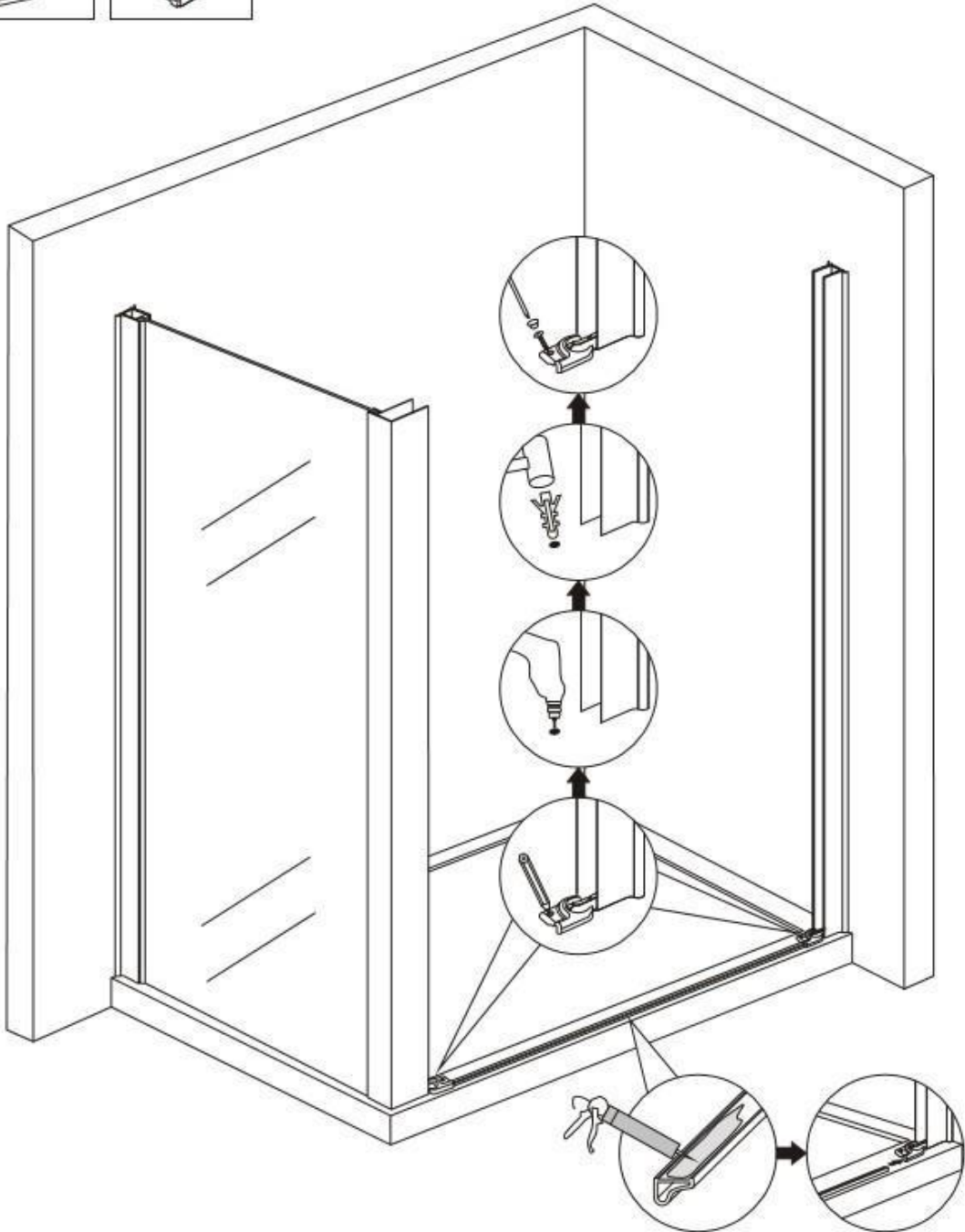
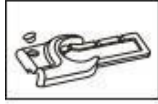
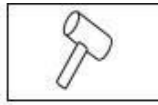
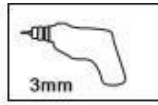
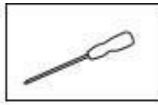
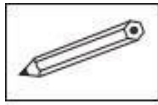

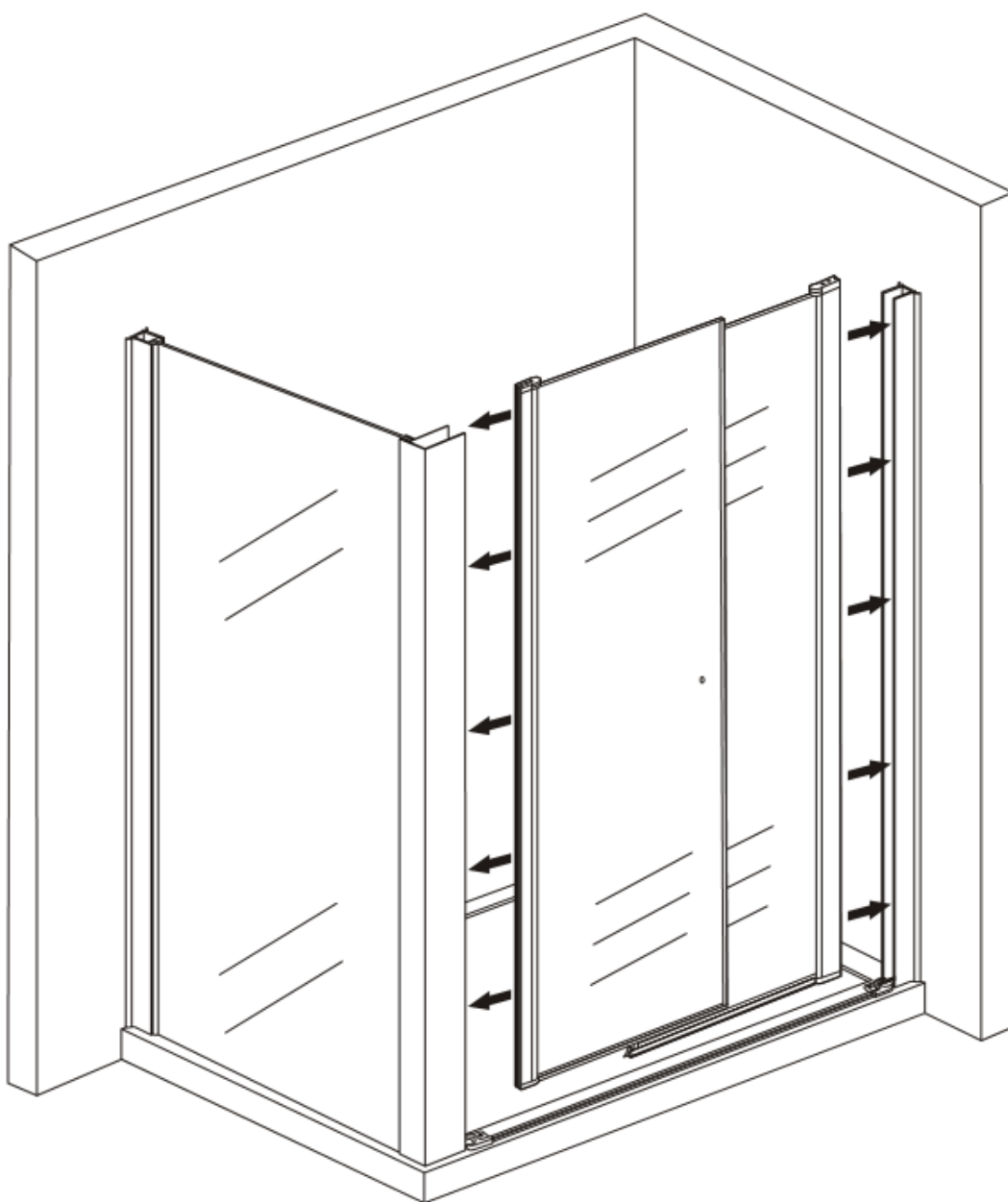
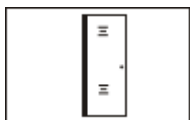

În timpul acestui proces, lăsați protectorul de margine pe sticlă



